

# OUTFLOW™ APD



## OUTFLOW™ APD

The **Outflow™ Locking Drainage Catheter** from Galt Medical is used for abscess drainage and fluid collections. The kink-resistant catheter is stiff enough to aid in pushability during insertion, yet soft enough for patient comfort. The Lubricity Plus® hydrophilic coating, 1cm length markings, and easy, secure locking mechanism provide the clinician with the tools needed for a reliable catheter placement.

- Kink-resistant, radiopaque catheter
- 1cm length markings
- Easy, secure, leak-resistant locking mechanism
- Large, skived drainage holes
- Lubricity Plus® hydrophilic coating
- 6Fr catheter accepts .035" guidewire
- Variety of kit configurations



For more information about the Outflow™ Locking Drainage Catheter or to set up a meeting with a Galt Sales Consultant call 1(800) 639-2800

# OUTFLOW™ APD

The Outflow™ Locking Drainage Catheter is simple to use:

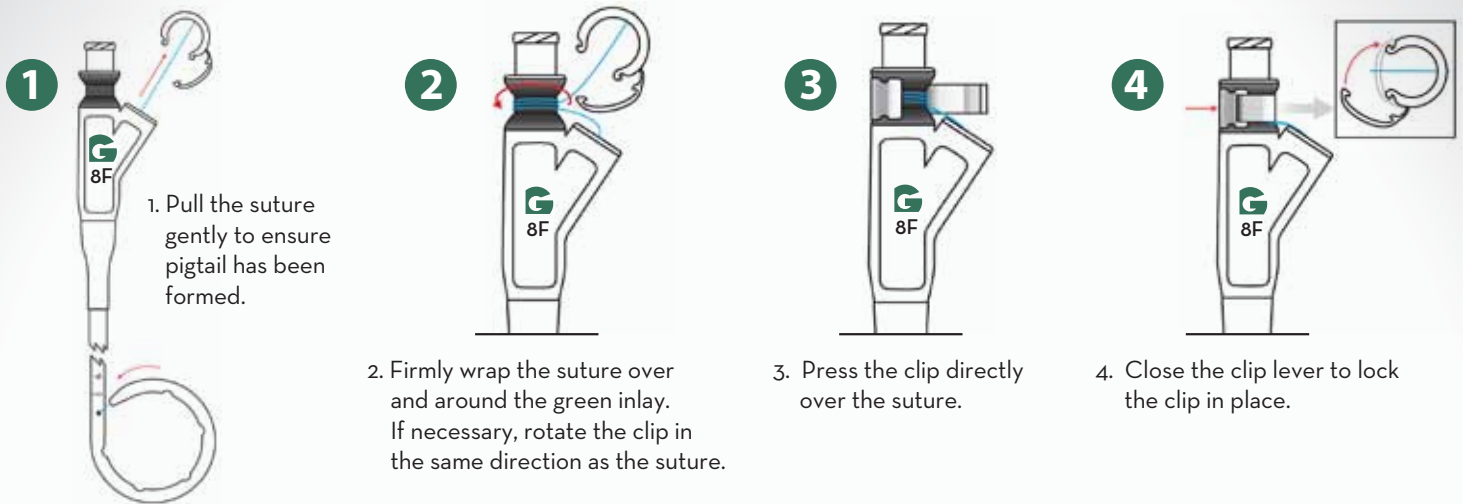

## Outflow™ All-Purpose Locking Catheter

Catalog Number	Introducer Size	Catheter Length	Accepts Wire Diameter	Drainage Holes	Tip Shape
KIT-048-06	6.0	25cm	.035"	5	Pigtail
KIT-048-08	8.0	30cm	.038"	5	Pigtail
KIT-048-10	10.0	30cm	.038"	5	Pigtail
KIT-048-12	12.0	30cm	.038"	5	Pigtail
KIT-048-14	14.0	30cm	.038"	5	Pigtail
KIT-048-18*	8.0	30cm	.038"	5	Pigtail
KIT-048-20*	10.0	30cm	.038"	5	Pigtail

Contents: Hydrophilic coated catheter, metal and/or flexible cannulas, trocar. \*Plastic cannula only

